

QUICK TIPS

Go Learn Mobile App – Using the Study Guide features for an iPhone

STEP 1: Download the **Go. Learn** app

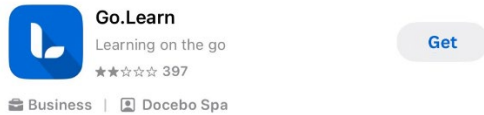

STEP 2: Log in to the Go Learn Mobile app using your [MAP™ Learning Portal](#) credentials.

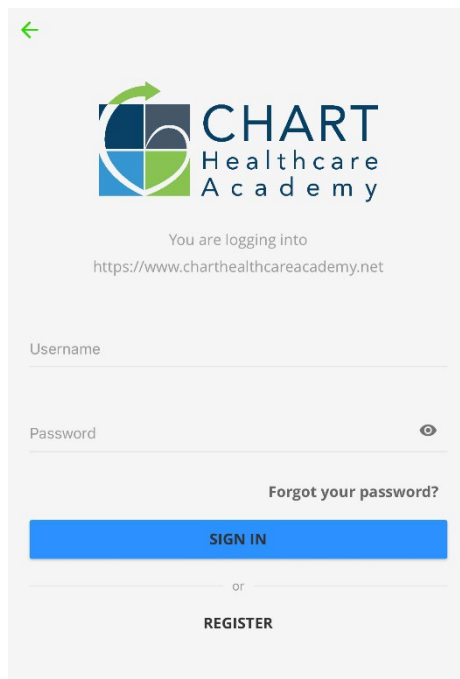

A screenshot of the login screen for the CHART Healthcare Academy mobile app. At the top is a green back arrow. Below it is the CHART Healthcare Academy logo. The text says 'You are logging into' followed by the URL 'https://www.charthealthcareacademy.net'. There are input fields for 'Username' and 'Password' (with an eye icon for toggling visibility). Below the password field is a link 'Forgot your password?'. A blue 'SIGN IN' button is centered below the links. At the bottom, there is an 'or' separator and a 'REGISTER' button.

STEP 3: Select the course you are interested in viewing.

QUICK TIPS

STEP 4: Select "Content."

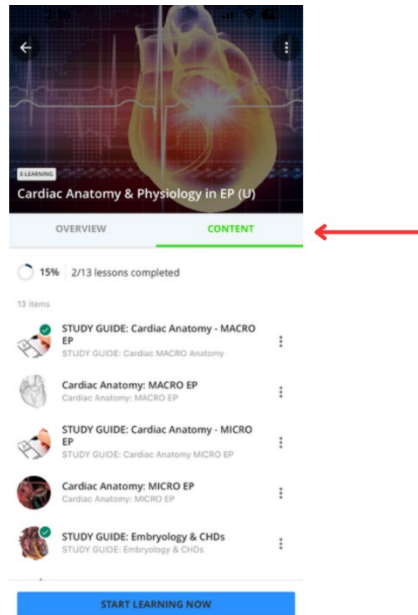

STEP 5: Select the "Study Guide" you are looking to use.

STEP 6: Select the blue "Download" and then "View" buttons.

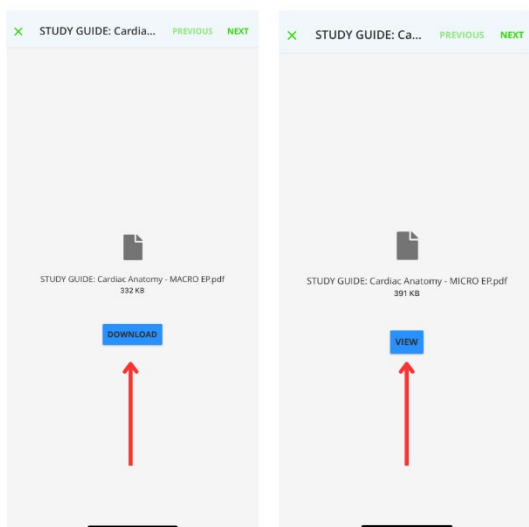

QUICK TIPS

STEP 7: Select “Markup” from the drop-down options.

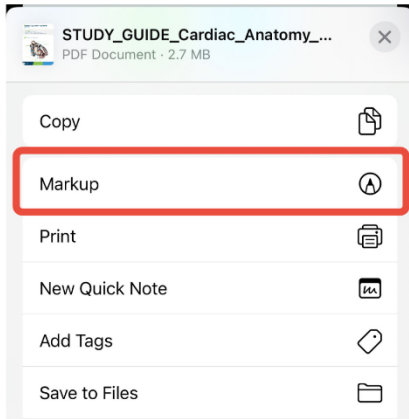

STEP 8: Select the annotatable feature at the top right-hand side (rectangle with 3 dots and pencil symbol). This will allow you to fill in the Study Guide.

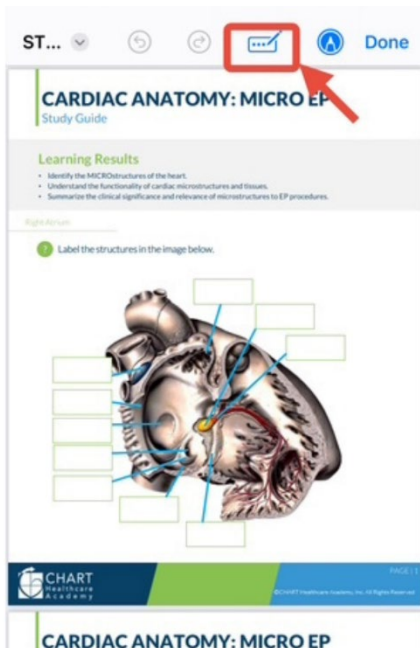

QUICK TIPS

STEP 9: Select the box you wish to type in and start typing.

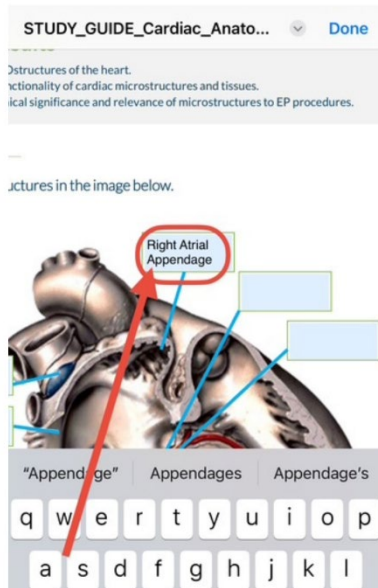

STEP 10: Once you have made your notes, select "done" to save your Study Guide.

